

△ 配套HC650插芯使用时此开孔宽度为43mm
Match with insert HC650, the distance
between the two openings is 43mm

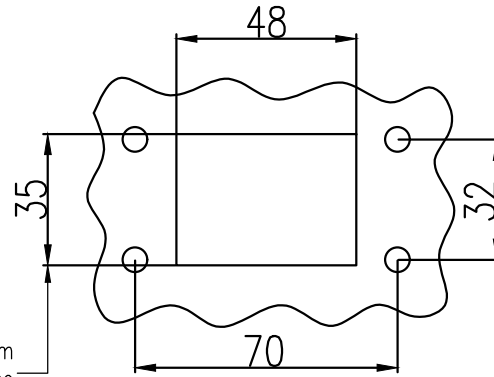

面板开孔图
Panel cut out

Note: △ 配套额定电流为650A的插芯 (HC650-M, HC650-F, HC650-MC, HC650-FC) 时, 该开孔尺寸宽度为43mm, 若面板强度足够, 能保证产品安装时, 面板不会出现变形, 适配其他规格的插芯时, 该开孔宽度亦可采用43mm.
match with inserts with rated current 650A(HC650-M, HC650-F, HC650-MC, HC650-FC), and the distance between the two openings is 43 mm. If the panel is strong enough to avoid distortion during assembly, the distance between the two openings still could be 43 mm, when the shell matches with other inserts.

技术参数:

- 材料: 压铸铝
- 表面处理: 粉末喷涂
- 颜色: RAL 9005 (黑色)
- 温度范围: -40℃ - +125℃
- 防护等级: IP68/IP69K
- 出线方向: 底部出线
- 密封元件: NBR

Technical specification:

- Material: aluminium die-cast
- Surface: powder-coated
- Colour: RAL 9005(black)
- Temperature range: -40℃ - +125℃
- Degree of protection: IP68/IP69K
- Cable entry: bottom entry
- Hoods/Housings sealing: NBR

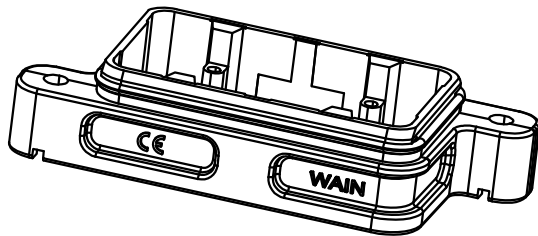

						表面处理 Finish		-		图号 Drawing No.		-	
						材料 Material		-		产品代号 Part Code		HP6B/H-BKH-2H	
标记 Mark		处数 Number		变更描述/Description		签名 Signature		日期 Date		产品料号 Part No.		1136063201002	
绘图 Drawn		姓名/Name		日期/Date		姓名/Name		日期/Date		比例 Scale		版本 REV.	
审核 Checked		JP HUANG		22.12.2023		-		-		2:1		V1.2	
工艺 Process		-		-		批准 Approved		HQ ZHANG		22.12.2023		重量 Weight	
										数量 Qty.		-	
										All Dimensions in mm Original Size DIN A 4		产品名称 Part Name	
												-	
												厦门唯恩电气有限公司 XIAMEN WAIN ELECTRICAL CO.LTD	