

技术参数:

- 插针数: 6(防开路)
- 额定电流: 40A
- 工作电压: 250V (AC)
- 耐电压: 2.0KV
- 绝缘电阻: $\geq 2000M\Omega$ (常态下)
- 接触电阻: $\leq 1m\Omega$
- 外壳材料: 铜合金镀镍
- 插针材料: 铜合金镀金
- 绝缘件: PA
- 密封件: 硅橡胶、氟胶
- 振动: $10-2000Hz, 147m/s^2$, 瞬断 $\leq 1us$
- 冲击: 加速度峰值 $490m/s^2$, 瞬断 $\leq 1us$
- 机械寿命: ≥ 500
- 锁定方式: 卡口锁定
- 线缆出线口直径: $\phi 13mm$
- 相对湿度: 90%-95% ($40^\circ C \pm 2^\circ C$ 时)
- 工作温度: $-40^\circ C \dots +105^\circ C$
- 防护等级: IP65

Technical specification:

- Number of contacts: 6 (The open circuit)
- Rated current: 40A
- Rated voltage: 250V (AC)
- Rated impulse voltage: 2.0KV
- Insulation resistance: $\geq 2000 M\Omega$ (normal temperature)
- Contact resistance: $\leq 1m\Omega$
- Material of housing: The copper alloy plating nickel
- Material of contact: Gold-plated copper alloy
- Material of insert: PA
- Sealing element: Silicone rubber, FKM
- Vibration: Frequency $10\sim 2000Hz$, accelerated speed $147m/s^2$, instant break $\leq 1us$
- Shock: Accelerated speed $490m/s^2$, instant break $\leq 1us$
- Mating cycles: ≥ 500
- Connector locking system: Bayonet locking
- Cable and outlet diameter: $10.5mm$
- Relative humidity: $90\% \sim 95\%$ ($40^\circ C \pm 2^\circ C$)
- Working temperature: $-40^\circ C \sim +105^\circ C$
- Pollution degree: IP65

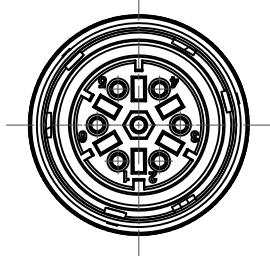
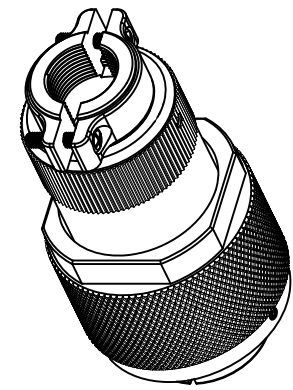
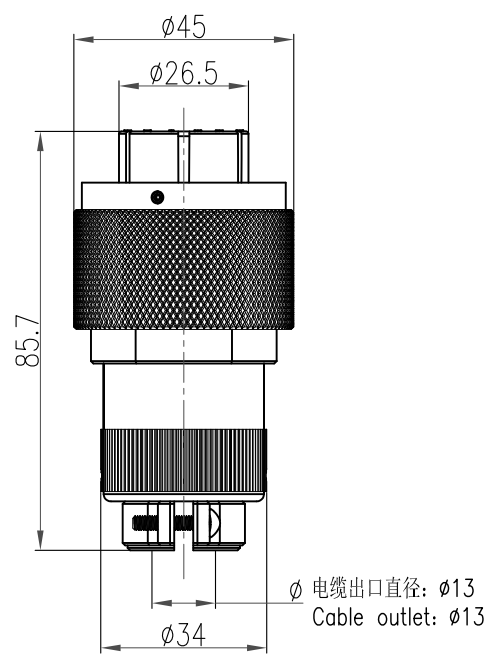

| | | | | | | | | | | | | | |
|---------------|--------------|------------------|----------------|-----------------|------------|---|------|---|--------------|-------------------|------------------|--------------------|---------------|
| | | | | | | 表面处理 Finish | | - | | 图号 Drawing No. | | - | |
| | | | | | | 材料 Material | | - | | 产品代号 Part Code | | HY-PT3006-S01E1-GF | |
| 标记 Mark | 处数 Number | 变更描述/Description | | 姓名 Signature | 日期 Date | 比例 Scale | | 版本 REV. | 重量 Weight | 数量 Qty. | 产品料号 Part No. | | 1690064231001 |
| 绘图 Drawn | TC CHEN | 姓名/Name | 日期/Date | 姓名/Name | 日期/Date | 1:1.5 | V1.0 | 373g | - | 产品名称 Part Name | | - | |
| 审核 Checked | ZM LIN | 01.08.2014 | 标准化 Stand. | - | - | All Dimensions in mm Original Size DIN A 4 | | 厦门唯恩电气有限公司 XIAMEN WAIN ELECTRICAL CO.LTD | | | | | |
| 工艺 Process | - | - | 批准 Approved | YY LUO | 01.08.2014 | | | | | | | | |